

Na Koa Ballroom



Venue spaces as impressive as the breathtaking views of Waikiki Beach and Diamond Head.



Experience the excitement of Waikiki and watch the beach come alive when you host your function at Outrigger Waikiki Beach Resort. Set on one of the most well-known beaches in the world, Outrigger Waikiki Beach Resort offers six venues totaling nearly 8,000 square feet of indoor/outdoor perfect for any occasion. Bring the undeniable power and energy surf culture surrounding the hotel creates to your business meeting or social event.

Venue and Meeting Inclusions

- Complimentary high-speed Internet and water station in all meeting rooms.
- Setup of room included in all rental prices.
- Upgraded features available through the hotel.
- Delicious fresh locally-sourced food available to cater to your event

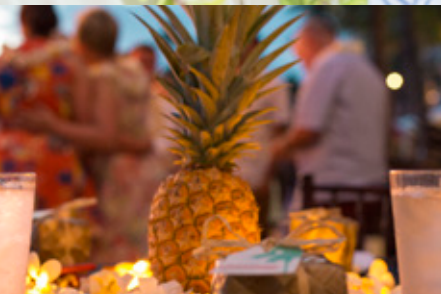

We'll work with you to plan and fulfill all details to ensure an unforgettable event.

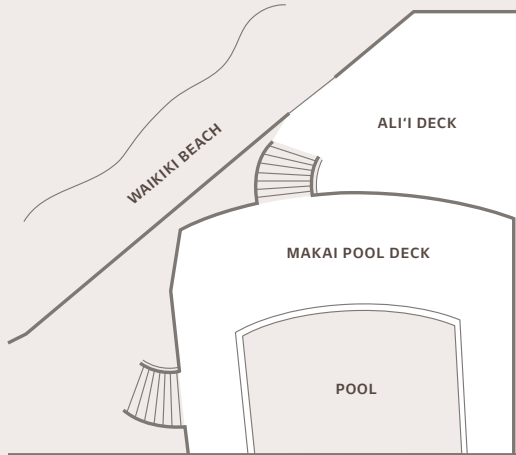
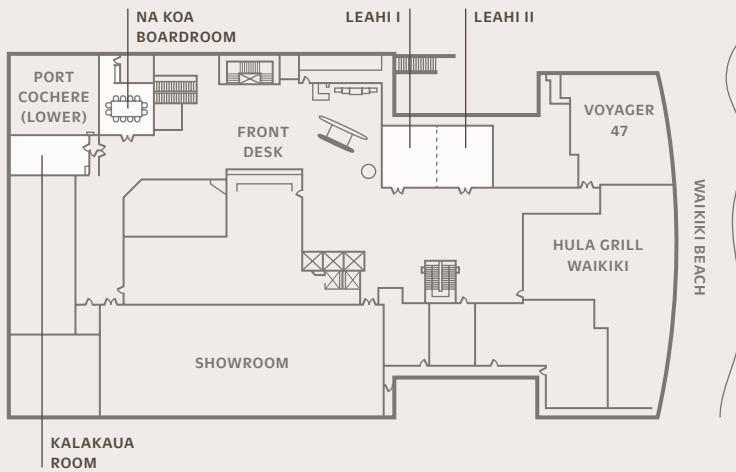

NA KOA BOARDROOM

Think of Na Koa Boardroom as your high level executive meeting room by the beach. The room offers a beautiful solid wood as beautiful as it is functional with built in outlets and fixed seating for up to 12. This room also offers a drop down projector screen and overhead LCD projector ready for all your conference needs.

LEAHI I AND LEAHI II

The combined Leahi Room is our largest meeting room with a sliding divider that can create two similarly sized breakout rooms. Both rooms offer drop down projector screens and can accommodate everything from banquets to seminars with ease.

KALAKAUA ROOM

This versatile room is located on our upper lobby and offers a view which overlooks Kalakaua Avenue and International Market Place. This room also offers a drop down projector screen and an overhead projector for ease of access.

VOYAGER 47

This oceanfront venue overlooks famous Waikiki Beach and offers spectacular views of Diamond Head and the Pacific Ocean. The ceiling to floor windows and wrap around lanai open up the venue to the sweet Hawaiian breeze to the perfect day or evening event. This space is available for day use from 11am to 4pm or evenings from 8pm to closing.

ALI'I DECK

This beautiful beach front deck offers an outdoor venue just steps from the sand with stunning views of Diamond Head and all of Waikiki Beach. Whether you're hosting an intimate gathering, cocktail party, or large scale reception this space is sure to create an unforgettable experience. When combined with the Makai Pool Deck and accommodate parties up to 90 guests and is available from 6pm to 10pm.

Function Room Capacities

Room	Dimensions	Area (Sq. Ft.)	Height	Conference Capacity	Classroom Capacity	Reception Capacity	Banquet Capacity	Theater Capacity
Na Koa Boardroom	24' x 22'	679	8'	12	—	—	—	—
Leahi I	27' x 24'	656	8'	24	25	40	40	50
Leahi II	27' x 25'	693	8'	24	25	40	40	50
Leahi I and II	50' x 27'	1,350	8'	50	50	80	80	100
Kalakaua Room	19' x 39'	741	8'	26	36	40	40	50
Ali'i Deck	—	768	—	—	—	30	40	—
Ali'i Deck & Makai Pool Deck	—	1,563	—	—	—	80	90	—
Voyager 47	—	3,480	8'	—	—	100	100	—

Outrigger Waikiki Beach Resort will be happy to help make your next business meeting or social function a complete success.

2335 Kalakaua Avenue
 Honolulu, Hawaii 96815
 Phone: 808-921-9780
 Fax: 808-921-9798
waikiki.events@outrigger.com

